



CITY OF FREEPORT

125 Main Street E – PO Box 301 – Freeport, MN 56331 – 320-836-2112 – FAX 320-836-2116
For TTY/TDD Users 1-800-627-3529 or 711 Minnesota Relay Service www.freeportmn.org

October 25, 2016, 2016 - Regular Meeting Agenda
Freeport City Hall - 7:00 pm

Call to Order

- I. Approve Agenda – *Motion to approve*
- II. Open Public Forum
- III. Consent Agenda – *Motion to approve*
 - a. Claims 2516 – 2544 (1-7)
 - b. September 27, 2016 Meeting Minutes (7-9)
 - c. October 5, 2016 Meeting Minutes (10)
- IV. Reports
 - a. Clerk Report (11-12)
 - b. Deputy Treasurer Report (13-30)
 - c. Public Works Report (31-34)
 - d. Engineer Report (N/A)
 - e. Attorney Report (35)
 - f. Fire Department Report (36-54)
- V. New Business
 - a. Resolution 2015-11 Authorization for Permit Off-Site Charitable Gambling for the Christian Mother Society Raffle (55)
 - b. Parking Ordinance (56)
- VI. Adjourn

Next meeting: November 29, 2016

10/12/16
09:44:14

CITY OF FREEPORT
Claim Approval List
For the Accounting Period: 10/16

Page: 1 of 2
Report ID: AP100V

* ... Over spent expenditure

Claim/	Check	Vendor #/Name/ Invoice #/Inv Date/Description	Document \$/ Line \$	Disc \$	PO #	Fund Org Acct	Object Proj	Cash Account
2516		15 ALBANY MUTUAL TELEPHONE	275.86					
	10252807	10/01/16 836-2411/2413	73.37			225 42200	320	10100
	10253197	10/01/16 836-7158	37.70			101 41000	320	10100
	10252969	10/01/16 836-2685	19.32			601 43225	320	10100
	10252969	10/01/16 836-2685	19.32			602 43250	320	10100
	10252666	10/01/16 836-2116	69.44			101 41000	320	10100
	10252664	10/01/16 836-2112	56.71			101 41000	320	10100
		Total for Vendor:	275.86					
2517		25 AMERIPRIDE LINEN & APPAREL	50.55					
	2200827759	09/16/16 Monthly rug service	50.55			101 41000	410	10100
		Total for Vendor:	50.55					
2518		70 CENTERPOINT ENERGY	35.95					
	09/21/16	Maintenance bldg	18.01			101 43100	382	10100
	09/21/16	Fire hall	17.94			225 42200	382	10100
		Total for Vendor:	35.95					
2519		76 CENTRAL MINNESOTA CREDIT UNION	256.14					
	09/30/16	Stearns Cnty Beacon fees	2.50			101 41000	433	10100
	09/30/16	UB postage	91.50			601 43225	200	10100
	09/30/16	UB postage	91.50*			602 43250	200	10100
	09/30/16	Water sample postage	3.40			601 43225	200	10100
	09/30/16	Laundry detergent fire dept	7.24			225 42200	210	10100
	09/30/16	Intermed Gov Acctg class	30.00			101 41400	330	10100
	09/30/16	Advanced Gov Acctg class	30.00			101 41400	330	10100
		Total for Vendor:	256.14					
2520		636 DHIA LABORATORIES	54.00					
	54161	09/13/16 Influent 627974	54.00			602 43250	460	10100
		Total for Vendor:	54.00					
2521		145 FINKEN WATER CENTERS	23.00					
	4229732	10/01/16 Water softener rental	15.00			101 41000	410	10100
	4229742	10/01/16 Maint water cooler	8.00			101 43100	410	10100
		Total for Vendor:	23.00					

10/12/16
09:44:14

CITY OF FREEPORT
Claim Approval List
For the Accounting Period: 10/16

Page: 2 of 2
Report ID: AP100V

* ... Over spent expenditure

Claim/	Check	Vendor #/Name/ Invoice #/Inv Date/Description	Document \$/ Line \$	Disc \$	PO #	Fund Org Acct	Object Proj	Cash Account
2522		387 RAHNS OIL & PROPANE, INC	370.03					
	91300	09/30/16 Fire dept fuel	102.54			225 42200	215	10100
	91300	09/30/16 Public Works fuel	245.54			101 43100	215	10100
	91300	09/30/16 EDA food	21.95			300 46500	210	10100
		Total for Vendor:	370.03					
2523		510 VERIZON WIRELESS	58.78					
	9772943906	10/01/16 Cell phone - Oct	58.78			101 43100	320	10100
		Total for Vendor:	58.78					
2524		525 XCEL ENERGY	2,070.43					
	517000003	09/19/16 Water tower	141.07			601 43225	381	10100
	518809669	10/03/16 Street lights	381.30			101 43160	381	10100
	518989099	10/04/16 302188142	133.86			601 43225	381	10100
	518989099	10/04/16 302252262	86.03			101 43160	381	10100
	518989099	10/04/16 302290398	111.26			101 41000	381	10100
	518989099	10/04/16 302679657	80.54			101 43100	381	10100
	518989099	10/04/16 302700297	23.99			602 43250	381	10100
	518989099	10/04/16 302947044	164.85			601 43225	381	10100
	518989099	10/04/16 303193187	23.62			602 43250	381	10100
	518989099	10/04/16 303616049	101.16			225 42200	381	10100
	518989099	10/04/16 303936749	45.85			101 43160	381	10100
	518989099	10/04/16 303956738	473.08			101 43160	381	10100
	518989099	10/04/16 303963984	238.87			101 43160	381	10100
	518989099	10/04/16 303985901	34.60			101 43160	381	10100
	518989099	10/04/16 304083816	12.87			101 43160	381	10100
	518989099	10/04/16 304098414	17.48			602 43250	381	10100
		Total for Vendor:	2,070.43					
		# of Claims	9	Total:	3,194.74			

10/20/16
12:00:57

CITY OF FREEPORT
Claim Approval List
For the Accounting Period: 10/16

Page: 1 of 4
Report ID: AP100V

* ... Over spent expenditure

Claim/	Check	Vendor #/Name/ Invoice #/Inv Date/Description	Document \$/ Line \$	Disc \$	PO #	Fund Org Acct	Object Proj	Cash Account
2525		712 BUECKERS SEPTIC SERVICE INC	35.00					
	1002	10/14/16 Lift station cleaning evaluatn	35.00			602 43250	311	10100
		Total for Vendor:	35.00					
2526		84 CITI LITES, INC.	31.50					
	52779	10/07/16 Mark streetlight wires	31.50			101 43160	300	10100
		Total for Vendor:	31.50					
2527		107 DANNY' S DISPOSAL & RECYCLING,	168.66					
	10/01/16	Maintenance bldg	139.25*			101 43100	383	10100
	10/01/16	Fire hall	29.41*			225 42200	383	10100
		Total for Vendor:	168.66					
2528		123 DYMOKE LAW OFFICE, P.A.	275.00					
	10/03/16	Fleegel property	110.00*			101 41000	302	10100
	10/03/16	Liquor license transfer	55.00*			101 41000	302	10100
	10/03/16	Council meeting	110.00*			101 41000	302	10100
		Total for Vendor:	275.00					
2529		611 EMERGENCY RESPONSE SOLUTIONS	8,002.79					
	7190	09/23/16 Transmitter assy, nightfighter	950.00*			225 42200	210	10100
	7190	09/23/16 AAA batteries	4.00*			225 42200	210	10100
	7190	09/23/16 Labor	95.00*			225 42200	210	10100
	7190	09/23/16 Shipping	17.25*			225 42200	210	10100
	7227	09/28/16 25 LED helmet lighting kits	1,295.00*			225 42200	210	10100
	7262	10/05/16 25 Fire helmets	5,295.00*			225 42200	210	10100
	7262	10/05/16 Shipping	346.54*			225 42200	210	10100
		Total for Vendor:	8,002.79					
2530		145 FINKEN WATER CENTERS	24.80					
	50319TF	10/01/16 4 5-gal drinking water bottle	24.80*			225 42200	210	10100
		Total for Vendor:	24.80					

10/20/16
12:00:57

CITY OF FREEPORT
Claim Approval List
For the Accounting Period: 10/16

Page: 2 of 4
Report ID: AP100V

* ... Over spent expenditure

Claim/	Check	Vendor #/Name/ Invoice #/Inv Date/Description	Document \$/ Line \$	Disc \$	PO #	Fund Org Acct	Object Proj	Cash Account
2531		626 FIRE SAFETY USA, INC.	30.00					
	93942	10/13/16 6 helmet decals	21.00*			225 42200	210	10100
	93942	10/13/16 Shipping	9.00*			225 42200	210	10100
		Total for Vendor:	30.00					
2532		174 GOPHER STATE ONE CALL, INC.	10.80					
	6090376	09/30/16 8 email tickets	5.40*			601 43225	300	10100
	6090376	09/30/16 8 email tickets	5.40*			602 43250	300	10100
		Total for Vendor:	10.80					
2533		194 HENNEN LUMBER CO, INC.	134.55					
	13703	09/08/16 12 bags cement	49.44*			101 45200	220	10100
	13903	09/14/16 4 bags cold patch	53.40			101 43100	225	10100
	14006	09/20/16 1 bag sakrete	4.19			101 43100	210	10100
	14006	09/20/16 4 bags yellow salt	27.52			101 43100	210	10100
		Total for Vendor:	134.55					
2534		195 HENRYS WATERWORKS, INC.	191.73					
	18706	10/11/16 15 Complete Pentagon Plug lids	176.85			601 43225	220	10100
	18706	10/11/16 Shipping & handling	14.88			601 43225	220	10100
		Total for Vendor:	191.73					
2535		668 JOAN WALL	123.63					
	10/17/16	Mileage - 2 Gov't Acctg class	123.63			101 41400	330	10100
		Total for Vendor:	123.63					
2536		219 JOANN TIMP	144.00					
	10/17/16	4 cleanings 9/26/16-10/17/16	144.00*			101 41000	300	10100
		Total for Vendor:	144.00					
2537		225 JOHN GILK	10.00					
	10/11/16	New Munich fire chiefs dinner	10.00			225 42200	335	10100
		Total for Vendor:	10.00					

10/20/16
12:00:57

CITY OF FREEPORT
Claim Approval List
For the Accounting Period: 10/16

Page: 3 of 4
Report ID: AP100V

* ... Over spent expenditure

Claim/	Check	Vendor #/Name/ Invoice #/Inv Date/Description	Document \$/ Line \$	Disc \$	PO #	Fund Org Acct	Object Proj	Cash Account
2538		248 LAKE REGION FIREFIGHTERS ASSN	40.00					
		2016 membership dues	40.00			225 42200	433	10100
		Total for Vendor:	40.00					
2539		529 LOREN GOEBEL	117.16					
		10/20/16 Mileage to water training/exam	97.75*			601 43225	330	10100
		10/20/16 Cell phone carrier	9.96			101 43100	320	10100
		10/20/16 Thermometers for wellhouses	9.45			601 43225	210	10100
		Total for Vendor:	117.16					
2540		334 M-R SIGN CO, INC	134.84					
		193013 10/13/16 2 stop signs	93.68			101 43100	210	10100
		193013 10/13/16 "Not a truck route" sign	31.86			101 43100	210	10100
		193013 10/13/16 Shipping	9.30			101 43100	210	10100
		Total for Vendor:	134.84					
2541		713 NATL FIN SVCS FBO FREEPT FIRE	17,463.15					
		10/01/16 Supplemental fire state aid	3,409.20*			225 42200	315	10100
		10/01/16 Fire state aid	14,053.95*			225 42200	315	10100
		Total for Vendor:	17,463.15					
2542		389 RAMLER TRUCK & TRAILER REPAIR,	254.24					
		CI019508 09/21/16 2 amber lenses	12.83*			225 42200	401	10100
		CI019508 09/21/16 2 light bulbs	1.44*			225 42200	401	10100
		CI019584 09/23/16 Amber lens	6.41*			225 42200	401	10100
		CI019584 09/23/16 Light bulb	0.72*			225 42200	401	10100
		RI039045 09/23/16 Replaced starter truck #404	232.84*			225 42200	401	10100
		Total for Vendor:	254.24					
2543		413 SCHLENNER WENNER & CO.	115.00					
		199424 09/30/16 Assist with state reporting	115.00*			101 41000	300	10100
		Total for Vendor:	115.00					

10/20/16
12:00:57

CITY OF FREEPORT
Claim Approval List
For the Accounting Period: 10/16

Page: 4 of 4
Report ID: AP100V

* ... Over spent expenditure

Claim/	Check	Vendor #/Name/ Invoice #/Inv Date/Description	Document \$/ Line \$	Disc \$	PO #	Fund Org Acct	Object Proj	Cash Account
2544		525 XCEL ENERGY	316.89					
	519745137	10/10/16 Street lights	316.89			101 43160	381	10100
		Total for Vendor:	316.89					
		# of Claims	20	Total:	27,623.74			

10/19/16
11:37:12

CITY OF FREEPORT
Liability Check Detail

Page: 1 of 1
Report ID: W120

Liability Check 19268 BLUE CROSS BLUE SHIELD 1416.87

Check #	Employee	Pay Date	Empl. Amount	Empr. Amount	Total Amount
-89205	Goebel, Loren C.	10/19/16	193.68	375.00	568.68
-89212	Goebel, Loren C.	10/05/16	193.68	375.00	568.68
-89204	Hennen, Adrianna M.	10/19/16	0.00	139.76	139.76
-89211	Hennen, Adrianna M.	10/05/16	0.00	139.75	139.75
Total Detail:		4	387.36	1029.51	1416.87



CITY OF FREEPORT

125 Main Street E – PO Box 301 – Freeport, MN 56331 – 320-836-2112 – FAX 320-836-2116
For TTY/TDD Users 1-800-627-3529 or 711 Minnesota Relay Service www.freeportmn.org

September 27, 2016 – Meeting Minutes

A regular meeting of the Freeport City Council was convened at 7:00pm by Mayor Rodney Atkinson with Councilmembers, Ken Goebel, Tim Hennen, Mike Eveslage and Ben Ettle present.

Staff in attendance: Clerk-Treasurer Adrianna Hennen, Deputy Treasurer Joan Wall, City Attorney Scott Dymoke, City Engineer Dave Blommel, Public Works Director Loren Goebel, and Maintenance Assistant Vernon Fuchs

Others in attendance:

Andrea Ramacher (720 1st Ave N)

Jim Notch (Freeport Lions)

Approve Agenda

T. Hennen moved to approve the agenda, seconded by K. Goebel. Motion carried 5-0.

Open Public Forum

No comments were given.

Consent Agenda

Eveslage moved to approve the consent agenda, seconded by K. Goebel. Motion carried 5-0.

Reports

Clerk Report

Council decided not to have A. Hennen attend the grant writing workshop.

Deputy Treasurer Report

No report was given.

Public Works Report

L. Goebel updated the council on the storm drain clean out. Atkinson asked if it was going to get done this year. L. Goebel is hoping so. L. Goebel also told council that he was in the process of locating every residents' water shut-off and documenting the location for city records.

Engineer Report

No report was given.

Attorney Report

No report was given.

Fire Department Report

Gilk told council a new starter had to be put in the rescue van. Gilk stated the Relief Assoc. bought 10 new pagers for the department. The department is also getting air pack repairs.

Gilk said a new pumper they are looking at will be about \$420,000 and hoping to have something for council to approve at the October meeting since the price of the truck goes up 4% in November. Gilk said Neil, the grant writer, said they can write two grants, one for turnout gear and one for a new pumper. It will just take two years to get the pumper then, if awarded the truck, one year to hear on the grant and then one year to get the truck. The department thinks they can sell their current pumper for \$30,000-\$40,000. K. Goebel moved to write two FEMA grants, one for turnout gear and one for the pumper, seconded by T. Hennen. Motion carried 5-0.

Old Business

Christmas Lights – Freeport Lions

Jim Notch attended the meeting to inform the council regarding what the Freeport Lions were intending on purchasing for Christmas Lights to be hung on the street lights. Notch stated they were looking at getting banners since they are narrower and less likely to get hit by semi's. Council agreed that if the Lions are purchasing the lights and decorations that they would be fine with whatever the Lions chose.

Harold Fleegal Property

A. Hennen informed the council that the EDA has decided to pursue the purchasing and demolition of the Fleegal property. A. Hennen stated there are a little over \$10,000 worth of assessments and Fleegal had said he owed \$4,000 on the house yet. A. Hennen also stated that Gerads gave a quick estimate of \$6,500 to tear the house down and fill it in. The EDA thinks they could sell the property for \$20,000. Eveslage asked if the EDA has enough money to do this in their budget. A. Hennen said they budget \$10,000 every year and rarely spend much of it. Dymoke stated that the EDA could borrow money from the City and then pay it back when the lot is sold.

Resolution 2016-08 2017 Preliminary Budget

A. Hennen asked if council wanted to begin budgeting for new street lights since it was going to cost upwards of \$200,000 to replace 29 of them on the main street. Eveslage suggested putting away \$30,000 per year so then in 6 years the city would be close to the amount. Atkinson suggested raising the levy from \$437,000 to \$470,000 for the preliminary so we can set aside money for the street lights and have extra in case anything else comes up until the time the budget is approved. T. Hennen moved to raise the proposed preliminary levy to \$470,000 seconded by Atkinson. Motion carried 5-0. Etle moved to approve Resolution 2016-08 with new the new preliminary levy of \$470,000, seconded by K. Goebel. Motion carried 5-0.

Water/Sewer Rates

There were no new updates

Adjourn

Mayor, Rodney Atkinson

City Clerk-Treasurer, Adrianna Hennen



CITY OF FREEPORT

125 Main Street E – PO Box 301 – Freeport, MN 56331 – 320-836-2112 – FAX 320-836-2116
For TTY/TDD Users 1-800-627-3529 or 711 Minnesota Relay Service www.freeportmn.org

October 5, 2016 – Meeting Minutes

A special meeting of the Freeport City Council was convened at 7:00 pm by Mayor Rodney Atkinson with Councilmembers, Ken Goebel, Tim Hennen, Mike Eveslage and Ben Ettle present.

Staff in attendance: Clerk-Treasurer Adrianna Hennen

Others in attendance: Freeport Fire Department Chief John Gilk, Firefighters Natascha Hennen, Chris Williams, and Larry Hoeschen. Dave Gruenes with Stearns Electric Association.

Resolution 2016-10 Requesting USDA REDLG Funding Through Stearns Electric Association

Dave Gruenes with Stearns Electric presented three financing options the City of Freeport might be eligible for, for the purchase of a new pumper fire truck. First, Gilk stated the truck will most likely be around the \$420,000 area from the options they have been looking at. The first option was a Community Facilities Direct Loan and Grant through USDA. Atkinson stated he didn't think Freeport would be eligible for that program because Freeport's median household income had increased and made Freeport ineligible for USDA grants. Gruenes stated that is something that can be looked into, but there are two other potential options. The second was a Rural Economic Development Loan Program through Stearns Electric and USDA. The maximum of this program is \$300,000 from USDA and then Stearns Electric must contribute 20% for a maximum combined total of \$360,000. It is a 10 year 0% interest, with a .5% yearly administrative cost to execute the program. Atkinson stated that would be a good plan for Freeport since the City is currently making .85% on the City's accounts. This is also a competitive program, which requires an application to be in the hands of the decision makers before any purchases are made and the application is prepared free of cost to the City by Stearns Electric Assoc. Gruenes stated another option was a program was through Stearns Electric Assoc. which is their revolving loan program. Gruenes stated he doesn't know exactly how much is in fund since money is always coming and going. Gruenes stated that Stearns Electric Assoc. is completely liable for the loan; there is a 3.5% interest rate. Council agreed there would be no reason to not try for the Rural Economic Development Loan Program since there is no cost incurred by the City in doing so and if the City was selected, the City would be saving money. Council agreed to apply for the full amount of \$300,000 for the Rural Economic Development Loan Program. Ettle moved to pass Resolution 2016-10 – "A Resolution Requesting USDA REDLG Funding through Stearns Electric Association", seconded by Eveslage. Motion carried 5-0.

Adjourn

Ettle moved to adjourn at 7:30, seconded by T. Hennen. Motion carried 5-0.

Mayor, Rodney Atkinson

City Clerk-Treasurer, Adrianna Hennen

Memo

From: Adrianna Hennen, Clerk-Treasurer

To: Freeport City Council

Date: 10/18/16

Re: Clerk Report

Private Lines vs. City Lines

Recently, a resident in town had a sewer backup in their basement. The resident was under the impression, and told by surrounding neighbors that since the blockage in the sanitary line was 60 feet into the line and across the street from their home that this was a City problem.

Unfortunately she was misinformed and residents should be aware that they are responsible for their entire line from their house to the point where it connects to the City's main line.

For this specific resident their private line ran through their yard and across the street where it connects to the City's main sanitary line.

If you ever hear residents confused on this topic, please explain to them or have them come speak to me.

Election

As you know, the General Election is fast approaching on November 8. The election will be held at city hall from 7am to 8pm. The public accuracy test will be held on October 27 at 10am. Residents had until Tuesday October 18th to register in advance. If they did not register by that date they will have to register the day of the election. Everyone is now able to vote absentee, in-person, at the Melrose City Center or at the Stearns Co Auditor/Treasurer office until November 7th. You can also send in an absentee ballot application form to Stearns Co. and they will mail you an absentee ballot to fill out and mail back to Stearns Co. Absentee ballot application forms can be picked up at Freeport City Hall.

Alley behind Credit Union/Freeport Floral/Freeport Screen Printing/Etc.

It was recently discovered that, what most thought was a public alley, is actually privately owned and not City property. Currently, the City has been plowing snow in this area, but since it is not ours, does council think the City should continue to do so? If so, what is the justification to continue?

Leaf Pick-Up

Spread the word – City wide leaf pick-up will be October 29th. Danny asks that the bags be left open and untied.

Christmas Decorations

Decorations have been purchased and will arrive sometime at the beginning of November. 10 banners (red, snow flakes and says "Merry Christmas" along with 20 feet of pre-lit garland is what was ordered. That will be combined with our other Christmas lights (snowflakes and lanterns) to decorate our main street.

Health Insurance

Loren and I will not be changing any of our health insurance plans, but premiums have increased. This will not affect the City at all, but instead more will be withheld from the employee to cover the increase.

Volunteer Recognition

I would like to take a moment to recognize all of the volunteers who put together Little League and other child related programs this summer and got those programs back up and running. If you see any of them, please thank them for their time and effort.

City of Freeport
All Funds Summary
For the Nine Months Ended September 30, 2016 (Unaudited)

	General Fund	AFSA Fund	TIF Swany White	EDA Fund	Bonds, 2013 Main Street Refunding	Bonds, 2012 Indust Park Refunding	2006 Small Cities Grant	Park Dedication	North End Park Fund	Bucket Fund Old Tower Preservation	Street Improv Fund	Capital Equip Fund	Water Fund	Waste Water Fund	Water USDA Reserve	Waste Water USDA Reserve	Total YTD Amount
REVENUES:																	
Property Taxes																	
Property Tax Levy	129,138			5,404	49,909	48,533											232,984
Other Taxes	0		1,458														1,458
General Sales and Use Tax													1,401				1,401
Special Assessments	0				6,498								16,798	0			23,297
Licenses and Permits	24,254																24,254
State Grants & Aid	55,861	23,496															79,357
Charges for Services	445												101,014	50,604			152,063
Public Safety		94,697															94,697
Fines and Forfeitures	1,053																1,053
Loan Payments Received							1,158										1,158
Miscellaneous	3,858	6,428		130	352	1,771	500	10	10	29	321	47	2,247	104			15,805
Total Revenues	214,608	124,621	1,458	5,534	56,759	50,304	1,657	10	10	29	321	47	121,461	50,708	0	0	627,526
EXPENDITURES:																	
General Government	24,303																24,303
Legislative (Council/Board)	2,580																2,580
Executive (Mayor/Manager)	714																714
Clerk	63,463																63,463
Elections	1,750																1,750
Auditor	18,585																18,585
Assessor	4,672																4,672
Planning / Zoning	138																138
Building Official	8,511																8,511
Public Works	46,630																46,630
Highways, Streets & Roadways	15,791									5,328							21,119
Street Lighting	13,194																13,194
Parks	8,001																8,001
Salaries & Benefits		0															0
Supplies		9,222		230									1,526	4,631			15,610
Professional Services		4,060		604							1,812		1,426	2,745			10,648
Fire Dept Aid		2,140															2,140
Training		4,118											113	113			4,343
Insurance		4,906											588	1,167			6,661
Utilities		3,058											4,189	778			8,025
Repairs		7,148															7,148
Water/Waste Water Treatment													3,992	572			4,564
Debt Service					123,695	180,063							57,740	4,200			365,698
Miscellaneous		2,971	1,458	65									1,491	0			5,985
Total Expenditures	208,331	37,623	1,458	899	123,695	180,063	0	0	0	0	7,140	0	71,065	14,206	0	0	644,480
Excess of Revenues																	
Over (Under) Expenditures	6,277	86,998	0	4,634	(66,936)	(129,759)	1,657	10	10	29	(6,819)	47	50,396	36,502	0	0	(16,954)
OTHER SOURCES (USES):																	
Transfers In	88,500	40,224	0	0	0	0	0	0	0	0	70,000	10,000	0	0	13,867	2,800	225,391
Transfers Out	(120,224)	(3,500)	0	(5,000)	0	0	0	0	0	0	0	0	(53,867)	(42,800)	0	0	(225,391)
Total Other Sources (Uses)	(31,724)	36,724	0	(5,000)	0	0	0	0	0	0	70,000	10,000	(53,867)	(42,800)	13,867	2,800	0
Excess of Revenues & Other Sources																	
Over (Under) Expenditures & Other Uses	(25,447)	123,722	0	(366)	(66,936)	(129,759)	1,657	10	10	29	63,181	10,047	(3,471)	(6,298)	13,867	2,800	(16,954)
FUND BALANCES:																	
January 1	443,813	427,870	0	133,722	151,642	453,322	88,421	1,704	1,740	5,239	0	0	2,015,251	2,072,213	41,601	8,400	5,844,939
September 30	418,366	551,592	0	133,356	84,706	323,564	90,079	1,713	1,750	5,268	63,181	10,047	2,011,780	2,065,914	55,468	11,200	5,827,985
CASH:																	
January 1	430,650	420,813	0	26,894	150,654	452,793	88,421	1,704	1,740	5,239	0	0	393,271	42,562	41,601	8,400	2,064,743
Increase (Decrease) in Cash	(15,310)	122,016	0	(291)	(65,948)	(129,230)	1,657	10	10	29	63,181	10,047	1,223	(24,933)	13,867	2,800	(20,870)
September 30	415,339	542,830	0	26,603	84,706	323,564	90,079	1,713	1,750	5,268	63,181	10,047	394,495	17,629	55,468	11,200	2,043,873

City of Freeport
Budget Variance Explanations
For the Nine Months Ended September 30, 2016 (Unaudited)

General Fund Revenue

Licenses & Permits:

Building Permits

Building permits from Worms Lumber, Marvin Enterprise, Mid Central Heating & AC, and MKI Enterprise

Miscellaneous:

Interest Earnings

Interest is now being allocated to appropriate funds every quarter instead of sitting in Gen Fund until year end

Rents and Royalties

FSB sign rent not yet received - came in Dec last year

Insurance Dividends

LMC dividend not yet received - came in Dec last year

General Fund Expenditures

Building Official

Offset by high building permit revenue

AFSA Fund Revenue

State Grants & Aid:

State Grants & Aid/PERA

Will be offset by check written to Relief Assn

Fire Dept Aid

Reimbursements for training costs and supplemental benefits for retired firefighter

AFSA Fund Expenditures

Salaries & Benefits

Firefighter salaries will be paid in December

Truck Repairs

Truck repairs needed

Miscellaneous

Suppl benefit pmt reimb to Relief Assn - offset by revenue

Water Fund Expenditures

Miscellaneous

Depreciation is posted during year end process

Waste Water Fund Expenditures

Operating Supplies

Lagoon bugs and weed killer weren't budgeted

Miscellaneous

Depreciation is posted during year end process

City of Freeport
General Fund
Statement of Revenues, Expenditures and Changes in Fund Balances
For the Nine Months Ended September 30, 2016 (Unaudited)

	Final Budget 2016	Year-to-Date Amount 9/30/16	Year-to-Date % of Budget 9/30/16	Variance With Final Budget
REVENUES:				
Property Taxes				
Property Tax Levy	238,500	129,138	54.1%	(109,362)
Other Taxes	3,000	0	0.0%	(3,000)
Special Assessments	675	0	0.0%	(675)
Licenses and Permits	8,925	24,254	271.8%	15,329
State Grants & Aid	112,121	55,861	49.8%	(56,261)
Charges for Services	100	445	445.0%	345
Fines and Forfeitures	1,500	1,053	70.2%	(447)
Miscellaneous	17,640	3,858	21.9%	(13,782)
Total Revenues	382,461	214,608	56.1%	(167,853)
EXPENDITURES:				
General Government	32,622	24,303	74.5%	(8,319)
Legislative (Council/Board)	5,756	2,580	44.8%	(3,176)
Executive (Mayor/Manager)	2,003	714	35.6%	(1,289)
Clerk	91,472	63,463	69.4%	(28,009)
Elections	2,950	1,750	59.3%	(1,200)
Auditor	25,260	18,585	73.6%	(6,675)
Assessor	5,000	4,672	93.4%	(328)
Planning / Zoning	6,250	138	2.2%	(6,112)
Building Official	4,200	8,511	202.6%	4,311
Public Works	93,377	46,630	49.9%	(46,747)
Highways, Streets & Roadways	38,761	15,791	40.7%	(22,970)
Street Lighting	20,500	13,194	64.4%	(7,306)
Parks	10,511	8,001	76.1%	(2,510)
Total Expenditures	338,662	208,331	61.5%	(130,331)
Excess of Revenues Over (Under) Expenditures	43,799	6,277	14.3%	(37,522)
OTHER SOURCES (USES):				
Transfers In	88,500	88,500	100.0%	0
Transfers Out	(120,224)	(120,224)	100.0%	0
Total Other Sources (Uses)	(31,724)	(31,724)	100.0%	0
Excess of Revenues & Other Sources Over (Under) Expenditures & Other Uses	12,075	(25,447)	-210.7%	(37,522)

FUND BALANCES:

January 1	443,813
September 30	418,366

	Balance 2016	Balance 2015
CASH:		
January 1	430,650	415,047
Increase (Decrease) in Cash	(15,310)	15,603
September 30, 2016/December 31, 2015	415,339	430,650

City of Freeport
AFSA Fund
Statement of Revenues, Expenditures and Changes in Fund Balances
For the Nine Months Ended September 30, 2016 (Unaudited)

	Final Budget 2016	Year-to-Date Amount 9/30/16	Year-to-Date % of Budget 9/30/16	Variance With Final Budget
REVENUES:				
State Grants & Aid	12,000	23,496	195.8%	11,496
Public Safety	90,583	94,697	104.5%	4,114
Miscellaneous	4,000	6,428	160.7%	2,428
Total Revenues	106,583	124,621	116.9%	18,038
EXPENDITURES:				
Salaries & Benefits	35,526	0	0.0%	(35,526)
Supplies	15,250	9,222	60.5%	(6,028)
Professional Services	4,400	4,060	92.3%	(340)
Fire Dept Aid	12,000	2,140	17.8%	(9,860)
Training	4,600	4,118	89.5%	(482)
Insurance	11,000	4,906	44.6%	(6,094)
Utilities	5,225	3,058	58.5%	(2,167)
Repairs	3,000	7,148	238.3%	4,148
Miscellaneous	1,350	2,971	220.1%	1,621
Total Expenditures	92,351	37,623	40.7%	(54,728)
Excess of Revenues				
Over (Under) Expenditures	14,232	86,998	611.3%	72,766
OTHER SOURCES (USES):				
Transfers In	40,224	40,224	100.0%	0
Transfers Out	(3,500)	(3,500)	100.0%	0
Total Other Sources (Uses)	36,724	36,724	100.0%	0
Excess of Revenues & Other Sources				
Over (Under) Expenditures & Other Uses	50,956	123,722	242.8%	72,766

FUND BALANCES:

January 1	427,870
September 30	551,592

	Balance 2016	Balance 2015
CASH:		
January 1	420,813	355,308
Increase (Decrease) in Cash	122,016	65,505
September 30, 2016/December 31, 2015	542,830	420,813

Cash Breakdown:

Truck Fund	335,620	284,647
Bldg/Equip Fund	5,826	4,620
Operating	201,384	131,546
	542,830	420,813

City of Freeport
TIF Swany White Fund
Statement of Revenues, Expenditures and Changes in Fund Balances
For the Nine Months Ended September 30, 2016 (Unaudited)

	Final Budget 2016	Year-to-Date Amount 9/30/16	Year-to-Date % of Budget 9/30/16	Variance With Final Budget
REVENUES:				
Tax Increments	3,000	1,458	48.6%	(1,542)
Total Revenues	3,000	1,458	48.6%	(1,542)
EXPENDITURES:				
TIF Payment	3,000	1,458	48.6%	(1,542)
Total Expenditures	3,000	1,458	48.6%	(1,542)
Excess of Revenues Over (Under) Expenditures	0	0	N/A	0
OTHER SOURCES (USES):				
Transfers In	0	0	N/A	0
Transfers Out	0	0	N/A	0
Total Other Sources (Uses)	0	0	N/A	0
Excess of Revenues & Other Sources Over (Under) Expenditures & Other Uses	0	0	N/A	0
FUND BALANCES:				
January 1		0		
September 30		0		

	Balance 2016	Balance 2015
CASH:		
January 1	0	1,445
Increase (Decrease) in Cash	0	(1,445)
September 30, 2016/December 31, 2015	0	0

City of Freeport
EDA Fund
Statement of Revenues, Expenditures and Changes in Fund Balances
For the Nine Months Ended September 30, 2016 (Unaudited)

	Final Budget 2016	Year-to-Date Amount 9/30/16	Year-to-Date % of Budget 9/30/16	Variance With Final Budget
REVENUES:				
General Property Taxes	10,000	5,404	54.0%	(4,596)
Miscellaneous	0	130	N/A	130
Total Revenues	10,000	5,534	55.3%	(4,466)
EXPENDITURES:				
Supplies	800	230	28.8%	(570)
Professional Services	2,000	604	30.2%	(1,396)
Miscellaneous	2,200	65	3.0%	(2,135)
Total Expenditures	5,000	899	18.0%	(4,101)
Excess of Revenues Over (Under) Expenditures	5,000	4,634	92.7%	(366)
OTHER SOURCES (USES):				
Transfers In	0	0	N/A	0
Transfers Out	(5,000)	(5,000)	100.0%	0
Total Other Sources (Uses)	(5,000)	(5,000)	100.0%	0
Excess of Revenues & Other Sources Over (Under) Expenditures & Other Uses	0	(366)	N/A	(366)
FUND BALANCES:				
January 1		133,722		
September 30		133,356		

	Balance 2016	Balance 2015
CASH:		
January 1	26,894	24,219
Increase (Decrease) in Cash	(291)	2,675
September 30, 2016/December 31, 2015	26,603	26,894

City of Freeport
Bonds, 2013 (Refunding of Main St Improvements)
Statement of Revenues, Expenditures and Changes in Fund Balances
For the Nine Months Ended September 30, 2016 (Unaudited)

	Final Budget 2016	Year-to-Date Amount 9/30/16	Year-to-Date % of Budget 9/30/16	Variance With Final Budget
REVENUES:				
General Property Taxes	92,500	49,909	54.0%	(42,591)
Special Assessments	8,281	6,498	78.5%	(1,783)
Miscellaneous	702	352	50.1%	(350)
Total Revenues	101,483	56,759	55.9%	(44,724)
EXPENDITURES:				
Debt Service	123,603	123,695	100.1%	92
Total Expenditures	123,603	123,695	100.1%	92
Excess of Revenues				
Over (Under) Expenditures	(22,120)	(66,936)	302.6%	(44,816)
OTHER SOURCES (USES):				
Transfers In	0	0	N/A	0
Transfers Out	0	0	N/A	0
Total Other Sources (Uses)	0	0	N/A	0
Excess of Revenues & Other Sources				
Over (Under) Expenditures & Other Uses	(22,120)	(66,936)	302.6%	(44,816)
FUND BALANCES:				
January 1		151,642		
September 30		84,706		

	Balance 2016	Balance 2015
CASH:		
January 1	150,654	0
Increase (Decrease) in Cash	(65,948)	150,654
September 30, 2016/December 31, 2015	84,706	150,654

City of Freeport
Bonds, 2012 (Refunding of Industrial Park)
Statement of Revenues, Expenditures and Changes in Fund Balances
For the Nine Months Ended September 30, 2016 (Unaudited)

	Final Budget 2016	Year-to-Date Amount 9/30/16	Year-to-Date % of Budget 9/30/16	Variance With Final Budget
REVENUES:				
General Property Taxes	90,000	48,533	53.9%	(41,467)
Miscellaneous	1,847	1,771	95.9%	(76)
Total Revenues	91,847	50,304	54.8%	(41,543)
EXPENDITURES:				
Debt Service	180,018	180,063	100.0%	45
Total Expenditures	180,018	180,063	100.0%	45
Excess of Revenues				
Over (Under) Expenditures	(88,171)	(129,759)	147.2%	(41,588)
OTHER SOURCES (USES):				
Transfers In	0	0	N/A	0
Transfers Out	0	0	N/A	0
Total Other Sources (Uses)	0	0	N/A	0
Excess of Revenues & Other Sources				
Over (Under) Expenditures & Other Uses	(88,171)	(129,759)	147.2%	(41,588)
FUND BALANCES:				
January 1		453,322		
September 30		323,564		

	Balance 2016	Balance 2015
CASH:		
January 1	452,793	0
Increase (Decrease) in Cash	(129,230)	452,793
September 30, 2016/December 31, 2015	323,564	452,793

City of Freeport
2006 Small Cities Grant
Statement of Revenues, Expenditures and Changes in Fund Balances
For the Nine Months Ended September 30, 2016 (Unaudited)

	Final Budget 2016	Year-to-Date Amount 9/30/16	Year-to-Date % of Budget 9/30/16	Variance With Final Budget
REVENUES:				
Loan Payments Received	0	1,158	N/A	1,158
Miscellaneous	0	500	N/A	500
Total Revenues	0	1,657	N/A	1,657
EXPENDITURES:				
Total Expenditures	0	0	N/A	0
Excess of Revenues Over (Under) Expenditures	0	1,657	N/A	1,657
OTHER SOURCES (USES):				
Transfers In	0	0	N/A	0
Transfers Out	0	0	N/A	0
Total Other Sources (Uses)	0	0	N/A	0
Excess of Revenues & Other Sources Over (Under) Expenditures & Other Uses	0	1,657	N/A	1,657

FUND BALANCES:

January 1	88,421
September 30	90,079

	Balance 2016	Balance 2015
CASH:		
January 1	88,421	79,760
Increase (Decrease) in Cash	1,657	8,661
September 30, 2016/December 31, 2015	90,079	88,421

**City of Freeport
Park Dedication
Statement of Revenues, Expenditures and Changes in Fund Balances
For the Nine Months Ended September 30, 2016 (Unaudited)**

	Final Budget 2016	Year-to-Date Amount 9/30/16	Year-to-Date % of Budget 9/30/16	Variance With Final Budget
REVENUES:				
Miscellaneous	0	10	N/A	10
Total Revenues	0	10	N/A	10
EXPENDITURES:				
Total Expenditures	0	0	N/A	0
Excess of Revenues Over (Under) Expenditures	0	10	N/A	10
OTHER SOURCES (USES):				
Transfers In	0	0	N/A	0
Transfers Out	0	0	N/A	0
Total Other Sources (Uses)	0	0	N/A	0
Excess of Revenues & Other Sources Over (Under) Expenditures & Other Uses	0	10	N/A	10

FUND BALANCES:

January 1	1,704
September 30	1,713

	Balance 2016	Balance 2015
CASH:		
January 1	1,704	1,692
Increase (Decrease) in Cash	10	12
September 30, 2016/December 31, 2015	1,713	1,704

City of Freeport
North End Park Fund
Statement of Revenues, Expenditures and Changes in Fund Balances
For the Nine Months Ended September 30, 2016 (Unaudited)

	Final Budget 2016	Year-to-Date Amount 9/30/16	Year-to-Date % of Budget 9/30/16	Variance With Final Budget
REVENUES:				
Miscellaneous	0	10	N/A	10
Total Revenues	0	10	N/A	10
EXPENDITURES:				
Total Expenditures	0	0	N/A	0
Excess of Revenues Over (Under) Expenditures	0	10	N/A	10
OTHER SOURCES (USES):				
Transfers In	0	0	N/A	0
Transfers Out	0	0	N/A	0
Total Other Sources (Uses)	0	0	N/A	0
Excess of Revenues & Other Sources Over (Under) Expenditures & Other Uses	0	10	N/A	10

FUND BALANCES:

January 1	1,740
September 30	1,750

	Balance 2016	Balance 2015
CASH:		
January 1	1,740	1,729
Increase (Decrease) in Cash	10	12
September 30, 2016/December 31, 2015	1,750	1,740

City of Freeport
Bucket Fund - Old Tower Preservation
Statement of Revenues, Expenditures and Changes in Fund Balances
For the Nine Months Ended September 30, 2016 (Unaudited)

	Final Budget 2016	Year-to-Date Amount 9/30/16	Year-to-Date % of Budget 9/30/16	Variance With Final Budget
REVENUES:				
Miscellaneous	0	29	N/A	29
Total Revenues	0	29	N/A	29
EXPENDITURES:				
Total Expenditures	0	0	N/A	0
Excess of Revenues Over (Under) Expenditures	0	29	N/A	29
OTHER SOURCES (USES):				
Transfers In	0	0	N/A	0
Transfers Out	0	0	N/A	0
Total Other Sources (Uses)	0	0	N/A	0
Excess of Revenues & Other Sources Over (Under) Expenditures & Other Uses	0	29	N/A	29

FUND BALANCES:

January 1	5,239
September 30	5,268

	Balance 2016	Balance 2015
CASH:		
January 1	5,239	5,204
Increase (Decrease) in Cash	29	36
September 30, 2016/December 31, 2015	5,268	5,239

City of Freeport
Street Improvements Fund
Statement of Revenues, Expenditures and Changes in Fund Balances
For the Nine Months Ended September 30, 2016 (Unaudited)

	Final Budget 2016	Year-to-Date Amount 9/30/16	Year-to-Date % of Budget 9/30/16	Variance With Final Budget
REVENUES:				
Miscellaneous	0	321	N/A	321
Total Revenues	0	321	N/A	321
EXPENDITURES:				
Professional Services	0	1,812	N/A	1,812
Highways, Streets & Roadways	0	5,328	N/A	5,328
Total Expenditures	0	7,140	N/A	7,140
Excess of Revenues				
Over (Under) Expenditures	0	(6,819)	N/A	(6,819)
OTHER SOURCES (USES):				
Transfers In	70,000	70,000	100.0%	0
Transfers Out	0	0	N/A	0
Total Other Sources (Uses)	70,000	70,000	100.0%	0
Excess of Revenues & Other Sources				
Over (Under) Expenditures & Other Uses	70,000	63,181	90.3%	(6,819)
FUND BALANCES:				
January 1		0		
September 30		63,181		

	Balance 2016	Balance 2015
CASH:		
January 1	0	0
Increase (Decrease) in Cash	63,181	0
September 30, 2016/December 31, 2015	63,181	0

City of Freeport
Capital Equipment Fund
Statement of Revenues, Expenditures and Changes in Fund Balances
For the Nine Months Ended September 30, 2016 (Unaudited)

	Final Budget 2016	Year-to-Date Amount 9/30/16	Year-to-Date % of Budget 9/30/16	Variance With Final Budget
REVENUES:				
Miscellaneous	0	47	N/A	47
Total Revenues	0	47	N/A	47
EXPENDITURES:				
Total Expenditures	0	0	N/A	0
Excess of Revenues Over (Under) Expenditures	0	47	N/A	47
OTHER SOURCES (USES):				
Transfers In	10,000	10,000	100.0%	0
Transfers Out	0	0	N/A	0
Total Other Sources (Uses)	10,000	10,000	100.0%	0
Excess of Revenues & Other Sources Over (Under) Expenditures & Other Uses	10,000	10,047	100.5%	47
FUND BALANCES:				
January 1		0		
September 30		10,047		
CASH:	Balance 2016	Balance 2015		
January 1	0	0		
Increase (Decrease) in Cash	10,047	0		
September 30, 2016/December 31, 2015	10,047	0		

City of Freeport
Water Fund
Statement of Revenues, Expenditures and Changes in Fund Balances
For the Nine Months Ended September 30, 2016 (Unaudited)

	Final Budget 2016	Year-to-Date Amount 9/30/16	Year-to-Date % of Budget 9/30/16	Variance With Final Budget
REVENUES:				
General Sales and Use Tax	2,000	1,401	70.0%	(599)
Charges for Services	156,200	101,014	64.7%	(55,186)
Miscellaneous	0	2,247	N/A	2,247
Total Revenues	158,200	121,461	76.8%	(36,739)
EXPENDITURES:				
Supplies	3,850	1,526	39.6%	(2,324)
Professional Services	4,300	1,426	33.2%	(2,874)
Training	200	113	56.3%	(88)
Insurance	798	588	73.7%	(210)
Utilities	6,300	4,189	66.5%	(2,111)
Water Treatment	8,175	3,992	48.8%	(4,183)
Debt Service	72,740	57,740	79.4%	(15,000)
Miscellaneous	73,830	1,491	2.0%	(72,339)
Total Expenditures	170,193	71,065	41.8%	(99,128)
Excess of Revenues Over (Under) Expenditures	(11,993)	50,396	-420.2%	62,389
OTHER SOURCES (USES):				
Transfers In	0	0	N/A	0
Transfers Out	(53,867)	(53,867)	100.0%	0
Total Other Sources (Uses)	(53,867)	(53,867)	100.0%	0
Excess of Revenues & Other Sources Over (Under) Expenditures & Other Uses	(65,860)	(3,471)	5.3%	62,389
FUND BALANCES:				
January 1		2,015,251		
September 30		2,011,780		

	Balance 2016	Balance 2015
CASH:		
January 1	393,271	416,304
Increase (Decrease) in Cash	1,223	(23,033)
September 30, 2016/December 31, 2015	394,495	393,271

City of Freeport
Waste Water Fund
Statement of Revenues, Expenditures and Changes in Fund Balances
For the Nine Months Ended September 30, 2016 (Unaudited)

	Final Budget 2016	Year-to-Date Amount 9/30/16	Year-to-Date % of Budget 9/30/16	Variance With Final Budget
REVENUES:				
Charges for Services	77,200	50,604	65.5%	(26,596)
Miscellaneous	0	104	N/A	104
Total Revenues	77,200	50,708	65.7%	(26,492)
EXPENDITURES:				
Supplies	1,112	4,631	416.5%	3,519
Professional Services	3,700	2,745	74.2%	(955)
Training	300	113	37.5%	(188)
Insurance	2,015	1,167	57.9%	(848)
Utilities	1,150	778	67.7%	(372)
Waste Water Treatment	2,020	572	28.3%	(1,448)
Debt Service	34,200	4,200	12.3%	(30,000)
Miscellaneous	62,525	0	0.0%	(62,525)
Total Expenditures	107,022	14,206	13.3%	(92,816)
Excess of Revenues Over (Under) Expenditures	(29,822)	36,502	-122.4%	66,324
OTHER SOURCES (USES):				
Transfers In	0	0	N/A	0
Transfers Out	(42,800)	(42,800)	100.0%	0
Total Other Sources (Uses)	(42,800)	(42,800)	100.0%	0
Excess of Revenues & Other Sources Over (Under) Expenditures & Other Uses	(72,622)	(6,298)	8.7%	66,324
FUND BALANCES:				
January 1		2,072,213		
September 30		2,065,914		

	Balance 2016	Balance 2015
CASH:		
January 1	42,562	68,522
Increase (Decrease) in Cash	(24,933)	(25,961)
September 30, 2016/December 31, 2015	17,629	42,562

City of Freeport
Water USDA Reserve
Statement of Revenues, Expenditures and Changes in Fund Balances
For the Nine Months Ended September 30, 2016 (Unaudited)

	Final Budget 2016	Year-to-Date Amount 9/30/16	Year-to-Date % of Budget 9/30/16	Variance With Final Budget
REVENUES:				
Total Revenues	0	0	N/A	0
EXPENDITURES:				
Total Expenditures	0	0	N/A	0
Excess of Revenues Over (Under) Expenditures	0	0	N/A	0
OTHER SOURCES (USES):				
Transfers In	13,867	13,867	100.0%	0
Transfers Out	0	0	N/A	0
Total Other Sources (Uses)	13,867	13,867	100.0%	0
Excess of Revenues & Other Sources Over (Under) Expenditures & Other Uses	13,867	13,867	100.0%	0

FUND BALANCES:

January 1	41,601
September 30	55,468

	Balance 2016	Balance 2015
CASH:		
January 1	41,601	0
Increase (Decrease) in Cash	13,867	41,601
September 30, 2016/December 31, 2015	55,468	41,601

City of Freeport
Waste Water USDA Reserve
Statement of Revenues, Expenditures and Changes in Fund Balances
For the Nine Months Ended September 30, 2016 (Unaudited)

	Final Budget 2016	Year-to-Date Amount 9/30/16	Year-to-Date % of Budget 9/30/16	Variance With Final Budget
REVENUES:				
Total Revenues	0	0	N/A	0
EXPENDITURES:				
Total Expenditures	0	0	N/A	0
Excess of Revenues Over (Under) Expenditures	0	0	N/A	0
OTHER SOURCES (USES):				
Transfers In	2,800	2,800	100.0%	0
Transfers Out	0	0	N/A	0
Total Other Sources (Uses)	2,800	2,800	100.0%	0
Excess of Revenues & Other Sources Over (Under) Expenditures & Other Uses	<u>2,800</u>	<u>2,800</u>	<u>100.0%</u>	<u>0</u>

FUND BALANCES:

January 1	<u>8,400</u>
September 30	<u><u>11,200</u></u>

	Balance 2016	Balance 2015
CASH:		
January 1	8,400	0
Increase (Decrease) in Cash	<u>2,800</u>	<u>8,400</u>
September 30, 2016/December 31, 2015	<u><u>11,200</u></u>	<u><u>8,400</u></u>

Memo

From: Adrianna Hennen, Clerk-Treasurer

To: Freeport City Council

Date: 10/18/16

Re: Public Works Report

Loren took his water operator test on Thursday, October 20th. Let's hope the best for Loren! We should find out his test score within the next couple of weeks. Loren will then be taking his wastewater operating test in March.

Job Duty	Date	Initial
Did well house, water tower, pond checks	SAT 9/24/16	LG
Did well house, water tower, pond checks	SUN 9/25/16	LG
Did well house, water tower, lift station, pond checks, did water sampling	MON 9/26/16	LG
got measuremnts of some curb stops, mowed lawn, gopher call	"	LG
Did well house, water tower, pond checks, worked on locating	TUE 9/27/16	LG
curb stops Fixed 2 betweel Jerome Hartung + Scott Blais, cleared	"	LG
lions park	"	LG
Did well house, water tower, pond checks, checked progress	9/28/16	LG
on storm drain ends Butch Thell is doing a did water testing	"	LG
For discharge + brought to Sawk Centre, Butch finished	"	LG
behind Bob Vanheels, did ditch across from Jennie Hiltner,	"	LG
turned water on at the Red Barn, Adri + I looked at Bob's Vanheels	"	LG
lawn to make sure it was good enough, met with Butch on	"	LG
when he was planning on finishing up a clean outs, picked	"	LG
up dog that had run gotten off lease, met with County Sheriff	"	LG
+ Found dog owner + they came + picked up.	"	LG
Did well house, water tower, pond checks	THUR 9/29/16	LG
Mike E. Fixed dead end + started pumping out hydrants for winter	"	ME
Did well house, water tower, pond checks, did water meter readings	FRI 9/30/16	LG
Flushed hydrants + pumped out for winter + put oil in them	"	LG/ME
Fixed some flags poles	"	LG
Did well house, water tower, pond checks	10/1/16	LG
Did well house, water tower, pond checks	10/2/16	LG
Did well house, water tower, pond, lift station checks, did water	10/3/16	LG
sampling, met with Adri + lady from wellhead protection, got paperwork	"	LG
ready for submitting, filed paperwork, mowed lawn, met w/	"	LG
Jersey Mayers about storm drains by church trying to see where they	"	LG
go where thinks they go into sanitary line + now is time to move if	"	LG
they are	"	LG
Did well house, water tower, pond checks, filled paperwork	10/4/16	LG
with Adri on computer + sent off. went to school	"	LG
+ tried to locate where that storm drain is going, mowed	"	LG
lawn.	"	LG
Did well house, water tower, pond checks, curb stop in yards	Wed 10/5/16	LG
mowed lawn	"	LG
Did well house, water tower, pond, lift station checks -	THUR 10/6/16	

Job Duty	Date	Initial
did water sampling, did curb stops on 8th street Found w/ll	10/6/16 ^{THUR}	LG
Fix when get parts in, Found dead end sanitary sewer back	"	LG
By Beutz house, on end of 5th Ave N. " traced water	"	LG
Flow from storm drain from school to see if goes to sanitary	"	LG
sewer.	"	LG
Did well house, water tower, pond checks, met with Tim	10/7/16	LG
Hobiger from Rural water + ran camera in by school to	"	LG
see where the line is and goes, also checked sanitary manhole behind	"	LG
John Henners ^{Henners} , cleaned shop - looked up to get some dye for	"	LG
running in lines to detect where it goes.	"	LG
Did well house, water tower, pond checks	10/8/16	LG
Did well house, water tower, pond checks	10/9/16	LG
Did well house, water tower, pond, lift station checks, did water	10/10/16	LG
testing, worked on finding curb shut offs.	"	LG
Did well house, water tower, pond checks, worked with Adri	10/11/16	LG
on putting shut offs + info on sheet for records.	"	LG
got measurements on curb stops + took pictures	"	LG/MT
went to school to see how they were hooking up ^{existing} storm drain	"	LG
to take out of sanitary	"	LG
Did well house, water tower, pond checks, mowed lawn	10/12/16	LG
met w/ Brian Z	"	LG
Did well house, water tower, pond, lift station checks,	10/13/16	LG
turned well houses down to 54 Hz to get ^{more} residual ^{back} in line.	"	LG
did shop water check residual is much better, did garbage, cleaned	"	LG
at ^{Long} park, talked with MNDOT about cleaning ditch farther		
east behind city shop.		
Did well house, water tower, pond checks, did water testing	10/14/16 ^{Fri}	LG
Did well house, water tower pond checks	10/15/16 ^{Sat}	LG
Did well house, water tower, pond checks	10/16/16	LG
Did well house, water tower, pond, lift station checks, did	10/17/16 ^{Mon}	LG
water sampling, checked sanitary line running from	"	LG
Hennen Lumber to Flow station resident stated the had	"	LG
backup in basement + thinks its a city problem, Flow was	"	LG
good talked with Ellington "Anderson" he stated the problem was	"	LG
a 9 feet + 40 feet + did not get to our sanitary line., had	"	LG
Johnson Jet line here to pump out lift stations + influent by ponds	"	LG

[illegible]

Dymoke Law Office, P.A.

300 Riverside Avenue NW

Melrose, Minnesota 56352

Telephone (320) 256-4205

Fax (320) 256-7201

October 18, 2016

Adrianna Hennen
City of Freeport
125 Main Street East
Freeport, MN 56331

BY ELECTRONIC MAIL

Re: Monthly Legal Report

Dear Ms. Hennen:

During the period from September 21, 2016 through October 18, 2016, we have not given significant attention any projects on behalf of the City of Freeport:

Respectfully submitted,
Dymoke Law Office, P.A.

by Scott E. Dymoke

Memo

From: Adrianna Hennen, Clerk-Treasurer

To: Freeport City Council

Date: 10/18/16

Re: Fire Department Report

Truck

Gilk will be presenting the pumper the truck committee has selected for council approval/denial. Dale from E1 will also be attending the meeting to explain anything about the truck the council may have questions on.

2 New Members

Gilk would also like approval of the addition of two new members Kevin Spohn and Ben Ettle. Both additions are contingent upon a background check and Ettle also needs to pass a physical examination. Both have passed their physical agility test, interview and both employers have agreed to allow them to participate on the department.

Adrianna Hennen

From: Dale Trettel <dale@firesafetyusa.com>
Sent: Thursday, October 20, 2016 12:39 PM
To: adrianna@freeportmn.org; jtgilk@albanytel.com
Subject: Freeport Fire - E-ONE Top Mount - 10/20/16 Price

Hello Chief Gilk and Adrianna,

The final price is \$418,978.43 for the E-ONE top Mount.

Thank You,

DALE TRETTEL

Fire Apparatus Sales

Fire Safety USA, Inc.

Toll Free: 877-699-3473

Mobile: 651-252-9761

dale@firesafetyusa.com | www.firesafetyusa.com





FREEPORT, MN

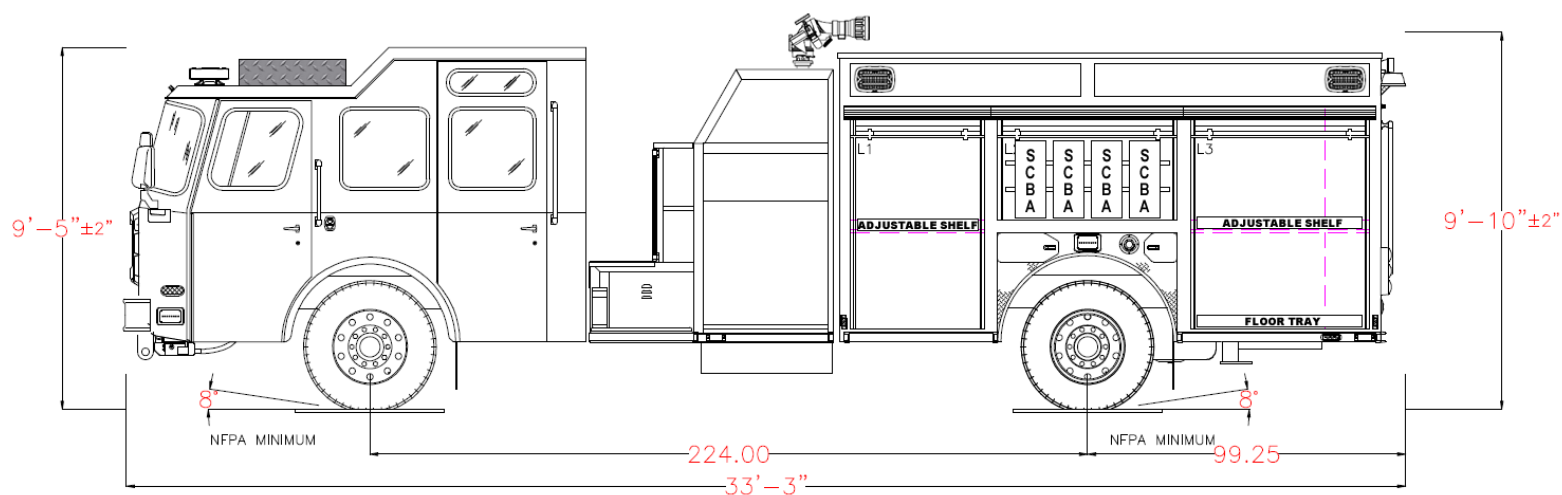
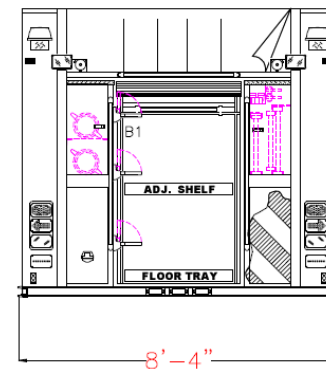

POWERED BY



This drawing provides a GENERAL REPRESENTATION of the vehicle configuration and should be used for evaluation purposes. The respective dimensions shown, including overall height and length, are estimates and may vary due to manufacturing processes. All other items such as lighting and fixtures, plumbing, compartmentation, and other generally assembled details are shown for REFERENCE ONLY and may not be a direct reflection of the final truck configuration. In all situations where this drawing may conflict with the specifications, THE SPECIFICATIONS, AS REFLECTED IN THE APPROVED SHOP ORDER, SHALL PREVAIL. Unless otherwise specified, the proposed apparatus will be manufactured to the latest NFPA recommendations as well as other applicable federally regulated safety regulations. E-One reserves the right to engineer and incorporate design improvements and changes without notice, while adhering to the intent of the specification.

8119/PAGE 1 OF 2

1250 GPM PUMP				HOSE LOADS :			
	OPENING			INTERIOR DIMENSIONS			
COMPT.	WIDTH	HEIGHT	WIDTH	LOWER HEIGHT	LOWER DEPTH	UPPER HEIGHT	UPPER DEPTH
L1	40	59.75	42	30	26	26.75	12
L2	54	25.75	56	N/A	N/A	26.75	12
L3	54	59.75	56	30	26	26.75	12
R1	40	59.75	42	30	26	26.75	12
R2	54	25.75	56	N/A	N/A	26.75	12
R3	54	59.75	56	30	26	26.75	12
B1	36	45	38	N/A	N/A	24	30

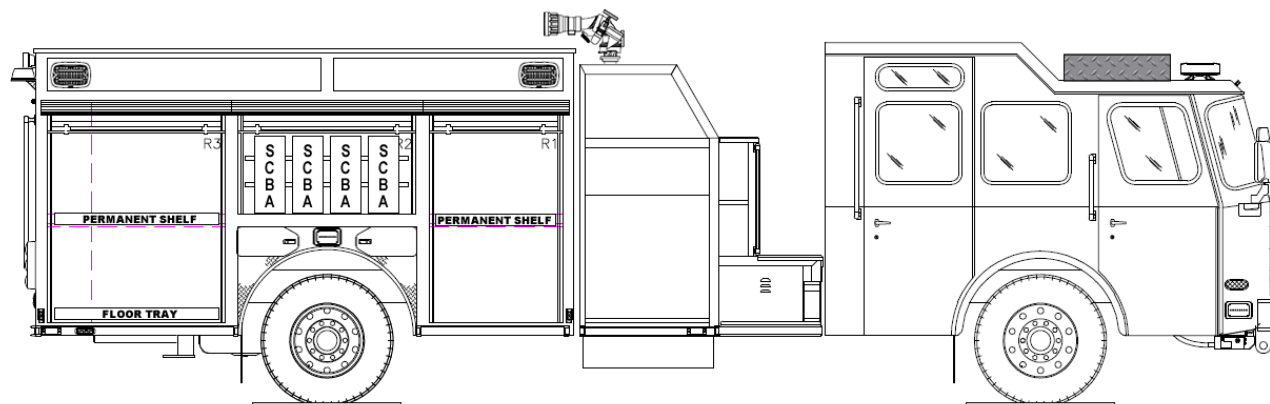
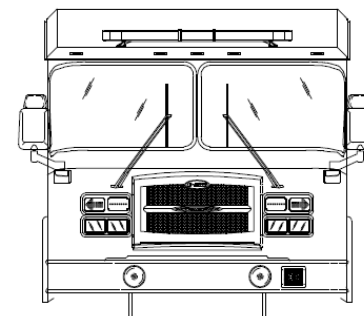



Fire Apparatus Quotation for: FREEPORT, MN



Quotation Number: 81197
Unit Description: PMPR-TYPH
Quote Description: Pumper, Typhoon

Salesperson: DALE

Salescode	Extended Description	Qty
TESTING COMPLIANCE STANDARD		
1001-0065	The E-ONE supplied components of the vehicle shall meet the requirements of NFPA 1901, 2016 edition.	1
3090-0002	OAH. Unit has no overall height restrictions.	1
3090-0004	OAL. Unit has no overall length restrictions.	1
3090-0007	Hosebed hoseload allowance on the apparatus shall be 1200 lbs.	1
3340-1137-12C	Equipment allowance on the apparatus shall be 2500 lbs. This allowance is in addition to the weight of the hoses and ground ladders listed in the shop order as	1
BUMPERS		
1160-0000	Bumper 10" stainless steel.	1
1160-0011	4" Front Bumper Extension.	1
FRAME ASSEMBLY		
1250-0011	Rear underbody support frame.	1
1250-0080	Frame assembly with 10.25 x 3.5 x .375 powder coated galvanized rails.	1
1250-0083	Frame liner 9.375 x 3.125 x .375, galvanized and powder coated.	1
AXLE OPTIONS		
1025-0017	Meritor RS-25-160 single rear axle 27,000 lb. capacity.	1
1025-0029	Front shock absorbers.	1
1025-0174	Meritor FL941 front axle 18,000 lb.	1
SUSPENSIONS		
1070-0001	Rear suspension springs rated equal to the capacity of the axle.	1

WHEEL OPTIONS		
1050-0007	Front axle wheel trim kit. Includes stainless steel lug nut covers (chrome plated plastic if applicable) and center cap with E-ONE logo. Note: Center cap will have an inspection port IPO a logo if equipped with Stemco oil seals.	1
1050-0008	Rear axle (single) wheel trim kit. Includes stainless steel lug nut covers (chrome plated plastic if applicable) and center cap with E-ONE logo. E-ONE custom chassis w/steel wheels will have chrome plated plastic lug covers.	1
1050-0044	Accuride aluminum wheels for front axle (2).	1
1050-0045	Accuride aluminum wheels for rear axle (4).	1
TIRE OPTIONS		
1060-0001	Two Michelin 315 tires model XZA-1 for front axle.	1
1060-0016	Four Michelin 12R rear tires with XDN2 all weather tread.	1
1060-0117	RWC AirGuard LED tire pressure monitoring valve stem caps (6) for single rear axle applications.	1
BRAKE SYSTEMS		
1100-0001	Meritor EX225H 17" disc brakes for front axle.	1
1100-0002	ArvinMeritor 16-1/2" x 7" S-cam brakes with cast brake drums for a single rear axle.	1
1100-0005	Brake system air 4X2/4X4.	1
1100-0006	Parking brake release mounted on the driver's side lower dash.	1
AIR SYSTEM OPTIONS		
1110-0000-001	Inlet for air system. Location: driver door jamb.	1
1110-0002	Air dryer Bendix AD-9.	1
1110-0006	Air lines nylon.	1
1110-0041	Air horns Grover recessed in bumper (PR).	1
1110-0044-179-02	Air inlet Auto-Eject. Includes Red weatherproof gasketed cover. Location: outside driver's door next to handrail.	1
ENGINES & TRANSMISSIONS		
1200-0017	Push-button transmission shift selector.	1
1200-0020	TransSynd synthetic transmission fluid for EVS3000.	1
1200-0097	Electronic limiting of speed to 68 MPH maximum. Note: Max speed may be set at 65 MPH due to tire rating.	1
1200-0311	Eng/Trans Cummins ISL 380HP/EVS3000 2016 EPA compliant engine.	1
SECONDARY BRAKING		
1125-0002	Jacobs engine compression brake.	1
1125-0023	Transmission to seek second gear when Jacobs engine brake or Telma retarder is engaged. N/A with Trans retarder.	1

COOLING PACKAGE		
1800-0013	Cooling system for use with Cyclone II X, Typhoon X, and Quest chassis. For use with 2010 / 2013 / 2016 EPA engines. Includes coolant recovery system.	1
FUEL SYSTEMS		
1350-0003	Fuel system 50 gallon.	1
1350-0022	Fuel line hose rubber.	1
ALTERNATOR		
1700-0003	Alternator Leece Neville 270 amp SAE, 240 amp NFPA rating.	1
BATTERIES		
1400-0002	Battery four group 31 1000 CCA.	1
CHASSIS OPTIONS		
1680-0006	Drivelines 1710.	1
1680-0008	Tow eyes front painted below bumper/cab (PR).	1
1680-0011	Tow eyes rear below body, painted.	1
1680-0118	Cold Weather Pkg for Cab. Includes fan clutch and additional insulation on the front wall and insulation on rear cab heater hose lines (if equipped).	1
1680-0250-M58	Diesel Exhaust Fluid (DEF) 5 gallon tank for 2013 / 2016 EPA engines. Location: left side below rear of cab.	1
1680-0284	Radiator mounted power steering cooler.	1
CAB MODEL		
1520-0012	Typhoon X long cab with 67.5" CA	1
CAB ROOF TYPE		
1615-0001	Vista full height rear doors, 12".	1
CAB BADGE PACKAGE		
1610-0000	Cab and body to have applicable E-ONE logos.	1
GRILLE		
1620-0004	ABS chrome plated grille.	1
CAB DOOR OPTIONS		
1550-0003	Rear crew cab doors in the medium position.	1
1550-0005	Driver and officer cab door windows. Include forward vent windows.	1
1550-0011	Rear crew cab door windows. Includes manual roll-down actuation. Not available on Typhoon or CII with paddle style door latching.	1
1550-0025	All cab doors shall have "L" style exterior latches.	1

1550-0027	Front cab door windows to have manual actuation.	1
1550-0059-000-G6	Reflective Red/Lemon Yellow printed striping positioned in the "A" formation located on the cab door panels.	1
1550-0072	Cab door panels aluminum painted Zolatone gray.	1
1550-0077	Interior cab door locks - manual. Will have manual actuation from each respective door. Includes barrel style key lock on each exterior cab door.	1
1550-0084	All cab exterior access doors to have 1250 keyed locks.	1
1550-0186-659	(4) TecNiq T440 4" LED cab step area lighting. Locate each light on each cab door in the inboard position. Lights to be switched with door ajar.	1

MIRRORS

1670-0001-274	Ramco 6001FFR mirrors. Remote controlled with top CAS750 convex. Location: mounted on front corners of cab.	1
1670-0013	Both cab mirrors to be heated.	1

MISC EXTERIOR CAB OPTIONS

1550-0020	Windows cab side fixed driver's side above wheel wells and at rear.	1
1550-0033	Windows cab side fixed officer's side above wheel wells and at rear.	1
1675-0022	Pair of 18" handrails located just behind driver and officer front door one each side.	1
1675-0024	Pair of 36" handrails located just behind driver and officer rear door (ALS doors if equipped) one each side.	1
1675-0030	Mud flaps, front, black with E-ONE logo.	1
1675-0049	Rear cab wall to be smooth 3/16" aluminum plate with a diamond plate overlay.	1
1675-0202	Mounting plate for battery charger receptacle, indicator, air inlet, etc (if applicable). Plate to be removable brushed stainless steel.	1

HVAC

1515-0017	Air conditioning for the Typhoon X, CII X and Quest with Cummins ISC/ISL engine and radiator mounted condenser.	1
1515-0053	Controls for heating and air conditioning shall be located in the center dash area. (Lower area on Typhoon and CII with severe duty dash)	1

HVAC

1685-0056	Heater rear cab w/o cover (PR) and front cab heater with heat to the feet for the driver and officer.	1
-----------	---	---

SEATS

1510-0003	Seats, Inc. brand 911 cab seats.	1
1510-0008	Seat color gray.	1
1510-0038	Driver seat 911 air ride.	1
1510-0040	Officer seat to be 911 air ride	1

1510-0050	Rear facing 911 seat with SCBA driver's side.	1
1510-0053	Rear facing 911 seat with SCBA officer's side.	1
1510-0122-130	Fold down seat with 911 SCBA back located driver's side outboard.	1
1510-0122-132	Fold down seat with 911 SCBA back located officer's side outboard.	1
1510-0203-148	Bracket SCBA IMMI SmartDock Gen2 restraint system. Location: rear facing driver's side.	1
1510-0203-150	Bracket SCBA IMMI SmartDock Gen2 restraint system. Location: outboard driver's side rear wall.	1
1510-0203-153	Bracket SCBA IMMI SmartDock Gen2 restraint system. Location: outboard officer's side rear wall.	1
1510-0203-215	Bracket SCBA IMMI SmartDock Gen2 restraint system. Location: rear facing officer's side.	1
1510-0234	Seat cover material Turnout Tuff.	1
1685-0033	Seating capacity tag of six occupants.	1

MEDICAL CABINETS

1535-0007	Medical cabinet mounted on rear wall of cab 55 x 40 x 20 with a locking roll up door. Lower door opening raised to provide hand clearance.	1
1535-0030	All roll-up medical cabinet doors selected on the cab to be ROM brand.	1
1535-0032	All medical cabinet RUD in the cab to be locking with 1250 key	1
1535-0202	Cab medical/storage cabinet(s) finish to be Zolatone gray. Includes interior/exterior of cabinet and shelves/trays if equipped.	1

MISC INTERIOR CAB OPTIONS

1685-0000	Cab interior gray. Does not include engine cover or seat color.	1
1685-0006	Padded sun visors, driver and officer's side overhead.	1
1685-0008	Control lanyard Y type for air horns.	1

MISC INTERIOR CAB OPTIONS

1685-0187	Severe duty engine cover, molded polyurethane.	1
1685-0369	Severe duty dash package with low profile officer side dash. Includes smooth plate alum center and officer side dash and lower kick panels; all painted to match cab interior.	1

CAB ELECTRICAL OPTIONS

1750-0013-172	Turn signal Whelen 600 LED amber arrow pair located upper headlight bezel.	1
1750-0024-179-04	Auto-Eject receptacle inlet 20 amp located outside driver's door next to handrail with a Yellow cover.	1
1750-0046-195	Cab Headlights. Position: lower.	1
1750-0072-592	12 VDC (or 24VDC) electrical outlet in the cab wired battery hot. Location: driver side dash.	1

1750-0075	English dominant main cab gauge cluster.	1
1750-0158	Dome Lts Red/White LED. Package includes two lights mounted in the front and two mounted in the rear of the cab. White light wired through door and light assembly switch. Red light through light assembly switch.	1
1750-0198-A31	Battery charger to be located behind driver's seat.	1
1750-0283	LED cab headlights. TyphoonX, CIIX and QST2 only.	1
1750-0343	Battery charger E-ONE LPC 20. 120 volt inlet, 20 amp output.	1
1750-0449	Momentary DPF regeneration override switch.	1

BODY COMPT LEFT SIDE

3100-0178	Driver side body with full height 42" wide forward and 56" wide rearward enhanced extended compartmentation. Includes (1) 56" wide compartment over the wheel well and one (1) storage tunnel.	1
3340-0045	(2) driver side roof top compartments. Includes hinged raised compartment lids with turn latches and grab handle(s). Each lid to have (1) bracket mounted LED light and to be wired to door ajar indicator in cab.	1

BODY COMPT RIGHT SIDE

3120-0283	Officer side body with full height 42" wide forward and 56" wide rearward enhanced extended compartmentation. Includes (1) 56" wide compartment over the wheel well and one (1) storage tunnel.	1
3340-0076	(2) officer side roof top compartments. Includes hinged raised compartment lids with turn latches and grab handle(s). Each lid to have (1) bracket mounted LED light and to be wired to door ajar indicator in cab.	1

BODY COMPT REAR

3110-0052	Bolt-on diamond plate tailboard (full width of rear compartment). Includes the enhanced extended side compartment frame work and handrails- (2) vertical on trailing edge of body and horizontal mounted handrail(s) below hosebed.	1
3110-0092	Enhanced Extended Compartmentation stepped down below hosebed level. Includes embossed diamond plate compartment tops.	1
3110-0095	Full Height Rear Compartment with Driver and Officer Side Storage Tunnels. Includes smooth plate panels and storage access doors with push button latches.	1

DOORS

3300-0017-004	Door roll up short (up to 45") with satin finish ROM. Location(s): L2.	1
3300-0017-016	Door roll up short (up to 45") with satin finish ROM. Location(s): R2.	1
3300-0019-003	Door roll up tall (greater than 45") with satin finish ROM. Location(s): L1.	1
3300-0019-005	Door roll up tall (greater than 45") with satin finish ROM. Location(s): L3.	1
3300-0019-015	Door roll up tall (greater than 45") with satin finish ROM. Location(s): R1.	1
3300-0019-017	Door roll up tall (greater than 45") with satin finish ROM. Location(s): R3.	1

3300-0019-027	Door roll up tall (greater than 45") with satin finish ROM. Location(s): B1.	1
SHELVES		
3370-0025-101	Shelf, permanent shelf. Locate in R1 at offset (above extrusion if applicable).	1
3370-0025-102	Shelf, permanent shelf. Locate in R3 at offset (above extrusion if applicable).	1
3370-0052-027	Adjustable shelf (J-Style) for non-transverse compartments 16" or greater in depth. Location: B1.	1
3370-0052-069	Adjustable shelf (J-Style) for non-transverse compartments 16" or greater in depth. Location: L1 lower.	1
3370-0052-071	Adjustable shelf (J-Style) for non-transverse compartments 16" or greater in depth. Location: L3 lower.	1
3370-0054-027	Tracks for adjustable shelf and/or adjustable tray in compartments 16" or greater in depth. Location: B1.	1
3370-0054-069	Tracks for adjustable shelf and/or adjustable tray in compartments 16" or greater in depth. Location: L1 lower.	1
3370-0054-071	Tracks for adjustable shelf and/or adjustable tray in compartments 16" or greater in depth. Location: L3 lower.	1
TRAYS / TOOLBOARDS		
3380-0076-005	Tray, floor mounted roll-out with gas spring. 500 lbs. capacity. Location: L3.	1
3380-0076-017	Tray, floor mounted roll-out with gas spring. 500 lbs. capacity. Location: R3.	1
3380-0076-027	Tray, floor mounted roll-out with gas spring. 500 lbs. capacity. Location: B1.	1
3380-0076-028	Four SCBA Brackets mounted in L2.	4
3380-0076-029	Four SCBA Brackets mounted in R2.	4
COVERS		
3305-0007-000-13	Vinyl Black hose bed cover with attached rear flap(s).	1
3305-0015-000-13	Vinyl Black speedlay front cover.	1
3305-0016-000-13	Vinyl Black speedlay side covers.	1
3305-0033	Vinyl access cover for fill tower(s).	1
PUMP MODULE		
3130-0167	Pump module to be 76" wide (side to side). Includes upper, lower, crosswalk, speedlay and tranverse module(s) if applicable.	1
3130-0525	Top mount pump module with walkway and integral double speedlays (9" W). Extruded aluminum with runningboards. Includes formed walkway access steps.	1
3130-0532	Pump panel opening is 39" wide. Pumper / tanker only.	1
3130-0552	Pump module height is 85". Pumper / tanker only.	1
PUMP PANELS		
3134-0015	Stainless steel TM control panel, driver and officer side pump panels.	1

3134-0145	Driver and officer side pump panel to be vertical hinged on forward extrusion. Panels to be (3) pieces with upper (2) panels secured in the closed position with push button latches. Upper panel to be held open with gas shock.	1
MISC PUMP PANEL OPTIONS		
4460-0003	Pump panel tags color coded per NFPA compliance.	1
PUMP MODULE OPTIONS		
3136-0006	Two (2) pump compartment heaters are to be mounted in the pump area. Locate as low as possible.	1
3136-0010	Stainless steel roller assemblies for crosslays and/or speedlays.	1
3136-0011	P-Rubber in flex joint(s) between pump module and/or body modules.	1
3136-0058	E-ONE logo mounted one each side on pump module/preconnect panels. Logos to be sized as applicable to available space on panels.	1
3136-0064	Heat pan. The lower area of the pump compartment to have a four (4) sided heat pan with two (2) removable (side to side) bottoms. Bottoms to be secured in the closed position with butterfly latches.	1
3136-0138	Pump module storage pan.	1
3136-0146	Compartments for TM walkway (PR). Includes hinged door each side with push button latch and LED compartment light. Requires TM pump module with walkway.	1
WATER TANK		
4010-0099	Fill tower(s) to be located offset to officer side of water tank.	1
4010-0179	1030 Gallon "R" Water Tank. UPF Poly III color fill towers. Note: Any foam cell(s) and/or storage options through the tank will reduce the overall water capacity.	1
TANK PLUMBING		
4450-0010	2" tank fill Akron manual valve.	1
4450-0119	3" tank to pump Akron manual valve w/4" tank connection.	1
FOAM TANK		
4100-0033-590-16	30 gallon integral foam tank for Class A foam. UPF Poly III Green fill tower. Foam tank capacity will reduce the water tank capacity.	1
LADDER STORAGE / RACKS		
3365-0049	Brand of ladders capable of being carried on unit to be Alco-Lite.	1
3365-0087-Z71	The length of ladders capable of being stored shall be the following: 35' 3-section, 14' roof ladder and 10' attic ladder w/shoes.	1
3365-0149-I31	Storage tunnel capable of holding: (2) 6" x 10' hardsuction hoses (individual vertical stacked) in Driver. One of which shall have a low level strainer pre-connected.	1
3365-0149-O97	Storage tunnel capable of holding: (1) 3-section, (1) roof, (1) attic, and (2) pike poles in Officer side rear storage compartment.	1

HANDRAILS / STEPS

3330-0277	Innovative Controls dual lighted LED folding steps rear NFPA. Includes folding steps on driver side rear of the body. (staggered stepped as applicable with tailboard depth) for NFPA hosebed access and handrail mounted on driver side upper hosebed side (as applicable).	1
-----------	--	---

MISC BODY OPTIONS

3340-0004	Hosebed above the booster tank. Includes forward hosebed and tower(s) cover plate work (as applicable). Hosebed adjustable divider extrusion rearward of the furthest tower is to run full width of the hosebed (as is practical with other hosebed mounted equipment).	1
3340-0015	Diamond plate single axle wheel well. Includes bolt-on composite wheel well liners and aluminum trim fenderettes.	1
3340-0035	Divider Long. To run full length of hose bed (front to rear).	4

MISC BODY OPTIONS

3340-0058	Recessed fuel fill driver side wheel well.	1
3340-0075	Body mainframe and hosebed side assemblies for a 90" high body.	1
3340-0093	Mud flaps, rear, black with E-ONE logo.	1
3340-0110	The rear of each hose bed divider to have a hand hold cut-out(s).	1
3340-0145	Rub rail for the body and pump area module(s).	1
3340-0302	Long hose bed divider(s) to be held short to allow for adjustability of the divider(s) with hose bed preconnect(s) if applicable per hose loading and option locations.	1
3340-0681	Body mainframe layout line to be 24". Includes body and all applicable modules.	1

SCBA BOTTLE STORAGE

3320-0100	Strap(s), loop style to retain SCBA bottle(s). Locate one per bottle in each exterior storage compartment.	1
3320-0182-497	E-ONE (1) SCBA bottle storage driver side rear wheel well offset rearward with hinged door and push button latch. Door material to match wheel well material. Door shall cover the recessed fuel fill if located adjacent to the SCBA storage.	1
3320-0183-495	E-ONE (2) SCBA bottle storage driver side rear wheel well offset forward with hinged door and push button latch. Door material to match wheel well material.	1
3320-0183-498	E-ONE (2) SCBA bottle storage officer side rear wheel well offset forward with hinged door and push button latch. Door material to match wheel well material.	1
3320-0183-500	E-ONE (2) SCBA bottle storage officer side rear wheel well offset rearward with hinged door and push button latch. Door material to match wheel well material.	1

PUMPS

4005-0030	Rating 1250 GPM	1
4005-0195	Hale QFLO 1250 GPM pump, single stage. Requires primer option.	1

PUMP CERTIFICATION		
4475-0000	Pump certification 1250 GPM	1
PUMP OPTIONS		
4015-0008	Zinc anodes for Hale pump (PR), (1) discharge side and (1) intake side.	1
4015-0053-198	Steamers to be Flush + 1". Location: driver's side.	1
4015-0053-199	Steamers to be Flush + 1". Location: officer's side.	1
4015-0056	Air operated master pump drain (upgrade).	1
4015-0238	Hale electric primer (oil-less).	1
INTAKES		
4440-0004-202	2.5" side suction top mount control handle Akron manual valve. Location: one on driver side pump panel and one on officer side pump panel.	2
INTAKE OPTIONS		
4445-0048	Intake pressure relief valve, Task Force Tips.	1
DISCHARGES AND PRECONNECTS		
4415-0014-581	2.5" Left Pump Panel Discharge Akron Manual Valve. Location: left side discharge 1.	1
4415-0016-583	2.5" Right Pump Panel Discharge Akron Manual Valve. Location: right side discharge 1.	1
4415-0016-584	2.5" Right Pump Panel Discharge Akron Manual Valve. Location: right side discharge 2.	1
4415-0022	2.5" hose bed discharges, one left side and one right side, enclosed/extended to	2
4415-0041	3" Deck Gun Discharge, Akron manual valve.	1
4415-0065	1.5" Double Speedlay with Akron Manual Valves.	1
4417-0106-L65	Deck gun piping to be positioned centered in deck gun channel.	1
DISCHARGE OPTIONS		
4417-0176	Innovative Controls 3/4" bleeder/drain valve include lift lever with ergonomic grip.	8
4417-0182	TM Valve controls to be Innovative Controls T-handles with grip activitated lock.	12
4417-0186	Innovative Controls discharge and intake bezels with color code and verbiage for top mount pump panel.	1
PRESSURE GOVERNORS		
4465-0011	Class 1 TPG pressure governor. Includes, water, oil, volt and tachometer.	1
GAUGES		
4435-0083	Innovative Controls 10 LED SL series water tank level gauge. On pump panel.	1
4435-0084	Innovative Controls 10 LED series foam tank level gauge. On pump panel.	1

4435-0246	2.5" Innovative Controls stainless steel case pressure gauge (0-400) with color code bezel.	8
4435-0247	4" Innovative Controls stainless steel case master pressure gauges with bezel. Intake 30-0-400, and discharge 0-400.	1
FOAM SYSTEMS		
4430-0014	Hale 2.1A FoamLogix foam system.	1
FOAM SYSTEMS		
4430-0079	The foam system performance shall be tested and certified in compliance with the applicable NFPA 1901 requirements.	1
FOAM SYSTEM OPTIONS		
4432-0053-562	Foam system plumbed to 1.5 first speedlay.	1
4432-0053-563	Foam system plumbed to 1.5 second speedlay.	1
WINTERIZATION		
4455-0004	Gasket Material around all Discharges, Intakes and Handle Slots on Pump Panel to hold in heat of Module Plumbing	1
ELECTRICAL SYSTEMS		
5010-0036	V-MUX Electrical system for pumper / tanker / rescue.	1
5010-0049	Vehicle data recorder - 2009 / 2016 NFPA compliant. Includes occupant detection shown in multiplex display. E-ONE chassis only.	1
5010-0055-649	Vista IV display for V-MUX electrical system. Location: driver's side engine cover.	1
LIGHT BARS		
5300-0504	Whelen MKEZ7 1.5" standard mount for front light bar (PR).	1
5300-0506-000-4T	Light bar LED color: Red with clear lenses	1
5300-0522	Light bar Whelen Freedom IV Model F4X0 60" with 8 LED modules. Location: Centered on the front cab roof.	1
WARNING LIGHT PACKAGES		
5550-0059-535	Whelen Super LED lower level warning light package. Includes (8) red 600 LED light heads and (2) red 500 LED light heads w/chrome flanges. Locate side facing lights: at forward most position, centered in rear wheel well, and side facing at rear of body in rubrail if equipped.	1
WARNING LIGHTS		
5600-0078-479-06	Whelen Super LED beacon (PR) model L31H with Red domes. Location rear upper body on aerial style brackets.	1
5600-0105-170	Hazard (door ajar) light 2" LED. Location: center overhead.	1

SIRENS		
5500-0009	Federal PA300 electronic siren recessed mounted.	1
5500-0024-170	The electronic siren control is to be located on the center overhead.	1
SPEAKERS		
5510-0029-209	Speaker, Federal Signal Dynamax ES100 with "E-ONE" grille through bumper. Location: driver side front bumper.	1
DOT LIGHTING		
5150-0017	License plate light LED with chrome housing located at the rear of the body.	1
5150-0025	Marker light LED body/cab package. E-One custom cab and pumper or tanker body only.	1
5150-0056	Whelen 600 series LED vertical mount tail lights. Includes LED stop/tail, arrow turn and back-up lights with vertical Cast 3 housing and weatherproof connectors.	1
LIGHTS - COMPARTMENT, STEP & GROUND		
5380-0162	Light recessed step Truck-Lite LED. Locate one each side of top mount walkway.	1
5380-0279	Ground light package TecNiq T440 4" LED - small.	1
5380-0311	Compartment light package Hansen LED for medium bodies. Includes two lights per compartment (four if transverse).	1
5380-0316	Compartment light Hansen LED for medical cabinet (PR).	1
LIGHTS - DECK AND SCENE		
5390-0058-395	Deck Lights - Truck-Lite LED model 81380 (PR). Location: rear body/beavertail area on the trailing edge up high.	1
5390-0069-861	Whelen M9 Linear Super LED scene lights (PR). Switched in cab (lights mtd on the sides of apparatus to be switched separately). Locate driver side forward and rearward areas of roof top storage compartment.	1
5390-0069-862	Whelen M9 Linear Super LED scene lights (PR). Switched in cab (lights mtd on the sides of apparatus to be switched separately). Locate officer side forward and rearward areas of roof top storage compartment.	1
5390-0076	Hose bed light Truck-Lite LED model 81380. Locate at front of hose bed. Switched with work light switch in cab.	1
LIGHTS - NON-WARNING		
5400-0003	Engine compartment light (EA).	1
5400-0011	LED pump compartment light (EA).	1
5400-0107	Weldon pump panel LED light package - top mount. Includes (2) lights per side pump panel and (3) lights for top mount panel. Side pump panels over 45" wide may require additional lights. Top mount only.	1

CAMERAS / INTERCOM		
5350-0070	Voyager back-up camera. Video displays automatically when transmission is in reverse. Camera only - does not include monitor.	1
MISC ELECTRICAL		
5110-0004	Alternating flasher for headlights.	1
5110-0017	Back-up alarm 97 dB.	1
LIGHT TOWERS		
5460-0074-993	Command Light Shadow LED light tower with (4) 150 watt 12V Whelen Pioneer PFP2 LED light heads. Control to be located next to the breaker box (L1 forward wall w/o breaker box). Tower to be located ahead of vista mounted side to side and hinged to driver side. Shall include diamond plate side shields.	1
RECEPTACLES		
5470-0004-545	Receptacle household 20A/110V duplex 3-prong NEMA 5-20 with cover plate interior mounted wired to inlet receptacle. Location: In cab driver side on 3 x 3 post rear facing just above engine cover.	1
5470-0004-546	Receptacle household 20A/110V duplex 3-prong NEMA 5-20 with cover plate interior mounted wired to inlet receptacle. Location: In cab officer side on 3 x 3 post rear facing just above engine cover.	1
5470-0004-746	Receptacle household 20A/110V duplex 3-prong NEMA 5-20 with cover plate interior mounted wired to inlet receptacle. Location: R3 high on forward wall.	1
MISC LOOSE EQUIPMENT		
7900-0014	DOT Required Drive Away Kit - Kit includes three (3) triangular warning reflectors with carrying case. This kit is for the end user and is to remain with the truck.	1
EXTERIOR PAINT		
8100-0064	Cab paint break - standard with dip to grille. Break is 31.5" inches below the drip rail on Typhoon X and CII X cabs. Pre-07' emission Typhoon cab break is 33.5" below the drip rail.	1
8100-0089	All applicable pump/pre-connect application modules are to have a sanded finish (not painted job color). Includes upper and lower pump modules, crosswalk module and/or speedlay/pre-connect module (as applicable). Rear mounted body/pump module to be painted job color.	1
8100-0116	Rear body surface to have a sanded finish (not painted job color). Includes hinged doors that do not have discrete sales codes and removable panels.	1
8100-0176-000-R5	Paint E-ONE chassis cab - Sikkens paint. Color: FLNA3225 Red (Sikkens published).	1
EXTERIOR PAINT		
8100-0177-000-44	Paint cab Sikkens two-tone. Upper area of cab to be painted FLNA4001 WHITE.	1
8100-0182-000-R5	Paint Body - Small - For Pumpers, Rear Mounts, S/A Tankers/Wetsides and Rescues. Sikkens paint. Color: FLNA3225 Red (Sikkens published).	1

INTERIOR PAINT		
8150-0011	The interior of the cab to be painted Zolatone gray.	1
LETTERING		
8200-0022	Customer Logo for front cab doors, pair	2
8200-0023	3" Gold Star letters with shade and outline, ENGINE 405, each side crew doors.	18
STRIPING		
8300-0006-334-12	NFPA Scotchlite Stripe - 6" wide with "Z". Stripe straight on front, sides and rear of cab and body. "Z" location to be specified by customer. Color: White. Location: bottom of stripe flush with top of bumper and straight back.	1
8300-0016	Paint Break Sign Gold Chassis Stripe - 3/4" Wide - Black, Gold, Black. To be located above existing paint break.	1
8300-0035	Striping Instructions:	1
8300-0039-000-12	Scotchlite stripe 1" located .5" above and below existing stripe. Color: White.	1
8300-0042	White rubrail scotchlite insert.	1
8300-0084-000-72	Chevron "A" style 6" printed sheet Scotchlite striping full width on rear of body. Includes rear facing extrusions, panels and doors. Colors to be Yellow/Red.	1
8300-0313	Yellow line to indicate designated standing / walking areas above 48" high in compliance with 2016 NFPA 1901. Line to be 1" wide. Steps, ladders and areas with a railing or structure at least 12" high are excluded from requiring the line.	1
GRAPHICS		
8400-0025-C52	A customer SignGold logo (up to 12") supplied to E-ONE in a digital format. Location: (1) each side front cab doors.	2
WARRANTY / STANDARD & EXTENDED		
9100-0000	Standard 1 Year Warranty.	1
9100-0003	Lifetime Frame Warranty.	1
9100-0004	10 Year/100,000 Mile Structural Warranty for Alum Cab / Body - Statement of Warranty.	1
9100-0005	10 Year Stainless Steel Plumbing Warranty - Statement of Warranty.	1
WARRANTY / STANDARD & EXTENDED		
9100-0019	10 Year Limited Paint and Perforation Warranty - For Sikkens Paint.	1
9100-0090	25 Year frame rail corrosion warranty. Includes liners (if equipped).	1
SUPPORT, DELIVERY, INSPECTIONS AND MANUALS		
9300-0009	Manuals, Operator and Service CD-ROM.	1
9300-0016	Approval Drawings-Standard.	1
9300-0316	Fire Apparatus Safety Guide published by FAMA, latest edition.	1

Dealer Supplied Equipment

Two manual 6" External Inlet valves to be provided.	1
Akron #3433 Hi Riser Dual Inlet Ground and Deck Monitor Pacakge.	1
All NFPA Ground Ladders shall be provided.	1
HGAC Fee is included.	1
Delivery and Training shall be provided.	1



CITY OF FREEPORT

125 Main Street E – PO Box 301 – Freeport, MN 56331 – 320-836-2112 – FAX 320-836-2116
For TTY/TDD Users 1-800-627-3529 or 711 Minnesota Relay Service www.freeportmn.org

RESOLUTION 2016-11

AUTHORIZATION OF PERMIT FOR OFF-SITE CHARITABLE GAMBLING FOR THE CHRISTIAN MOTHER SOCIETY RAFFLE

It is hereby resolved by the City of Freeport, Minnesota that:

WHEREAS; The Freeport Lions have requested of the City of Freeport authorization for an off-site tax exempt gambling permit on November 28, 2016 at Sacred Heart Church for the Christian Mother Society Raffle;

WEHREAS; The Freeport City Council has the authority to grant authorization for tax exempt gambling permits within Freeport City limits; and

WHEREAS; The Freeport City Council desires to support the ongoing efforts of area non-profit and community service organizations;

THEREFORE; The Freeport City Council grants the authorization to the Freeport Lions for an off-site permit for tax exempt gambling on November 28, 2016 at Sacred Heart Parish.

It is hereby certified that this resolution was formally adopted by the City Council of Freeport, Minnesota on this 25th Day of October 2016.

Motion by:

Second by:

Council members in favor:

Council members opposed or abstained:

ATTEST:

Rodney Atkinson, Mayor

Adrianna Hennen, City Clerk-Treasurer

Memo

From: Adrianna Hennen, Clerk-Treasurer

To: Freeport City Council

Date: 10/19/16

Re: Campers-Parking on Street

As of late I have been getting more complaints of residents parking their campers, boats, trailers, etc. in front of their house on the street. Currently, the only ordinance we have that would try to deter this is a “no parking in the same spot for more than 2 days” rule. Unfortunately, that doesn’t stop someone from moving it to a slightly different location every couple of days.

I’m wondering if council would agree to develop an ordinance that would deter campers and/or other recreational vehicles and equipment from being parked on the street for an extended period of time?